

CGA Brass Tailpieces

Ordering Information

Part Number	CGA Connection	Thread of Bore for Tubing	Length (Approx.)	Maximum Operating Pressure
2603-2U	510, 580, 590	1/4" NPT	1 3/32"	3000 psig (206 barg)

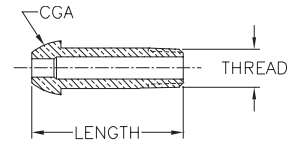

Miscellaneous Brass Tailpiece

Ordering Information

Part Number	For Use with Nut (RH or LH)		Figure	Thread of Bore for Tubing		Length (Approx.)		Maximum Operating Pressure
	Inches	mm		Inches	mm	Inches	mm	
2233-3A	1" - 11 1/2 NPS	25-292	1	1/2" NPT	13	37/16"	87	3000 psig (206 barg)
2670-35			2	.312 I.D.	8	27/16"	62	

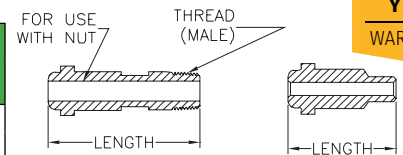

Fig 1 THREADED

Fig 2 SWEAT END

Brass Union Connection Nuts

Ordering Information

Part Number	Figure	Thread Connection		Wrench Flats		Maximum Operating Pressure
		Inches	mm	Inches	mm	
1302-1	2	9/16" - 18-LH	17-457	1 1/16"	17	3000 psig (206 barg)
1271-1		7/8" - 14-RH	22-356	1 1/8"	29	
1371-1		7/8" - 14-LH	22-356			
2223-6		1" - 11 1/2 NPS-RH	25-292	1 3/4"	44	
2223-6A		1" - 11 1/2 NPS-LH	25-292			

Internal Threads

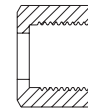

Candy Cane Riser Tubes and Assemblies For Piping-Away PRV9400, SS9400, PRV19400 & PRV29400 Series Relief Valves from Cryogenic Piping.

Materials

Tubing: Stainless Steel
 Fitting: Brass

Ordering Information

Part Number	Tubing Material	Fitting Material	"A" PRV Connection		"B" Tubing OD		"C" Inlet Connection		Maximum Operating Pressure
			Inches	mm	Inches	mm	Inches	mm	
1332SS	Stainless Steel	Brass	1/4" FNPT	6	.375"	9	Tubing 0.375"	9	600 psig (41.37 barg)
1334SS			1/2" FNPT	13			.625"		
1344SS					1/2" FNPT	13		.625"	
1344SSA			1/2" FNPT	13			.625"		

