

Flanged ESVs for Bulk Plants FA6010, FA6016 and FA6024

Application

Designed for installation in liquid transfer lines at LP-Gas or Anhydrous Ammonia bulk plants to provide for quick shut-off of liquid or vapor flow in the event of an accidental pull-away, line break, or hose rupture.

Features

- Fusible Element is located in the thermal fuse assembly which acts at the latch open and close trigger. When exposed to fire, the element melts at 212° F allowing the shaft to return to the closed position.
- Valve can be opened by use of operating lever, if a pneumatic actuator is used it will open with the actuator.
- Valve can be closed by remote cable or pneumatic actuator.
- Valve can be closed by simply pushing the operating lever down. It is not necessary to trip the close trigger.
- Seat Disc is retained by a metal seat to minimize leakage in case of direct fire impingement.
- Quick closing regardless if the pump is running or not.

Sturdy Rugged Construction

- Will withstand hydraulic shock of sudden closings, piping strains, and temperature variations.
- Valve has only two moving parts, stem and close/thermal trigger.
- UL listed for use in LP-Gas as an emergency and operating shut-off valve.
- Stem seals are spring loaded for leak free performance at low temperatures/pressures.

Materials

Body Ductile Iron Cad Plated
 Stem Stainless Steel
 Seat Stainless Steel
 Seat Disc (FVA6010/16/24) High Temperature Viton
 Seat Disc (FA6010/16/24) Nitrile
 Springs Stainless Steel
 Stem Seals Teflon



FA6010

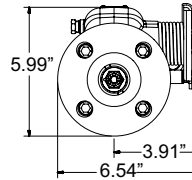
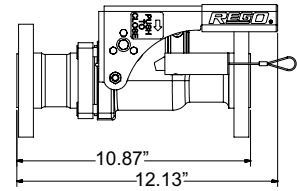

FA6016

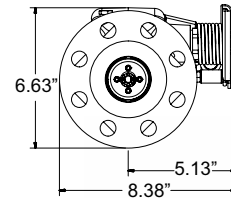
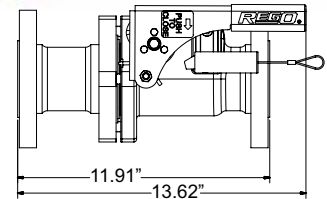

FA6024

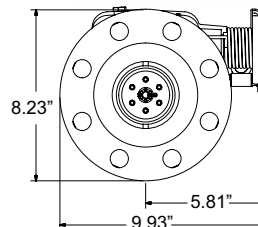
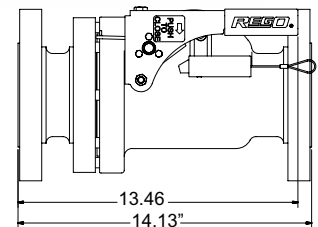

Ordering Information

Part Number	Seat	Inlet and Outlet Connections	Liquid Flow Capacity at 10 PSIG Drop (GPM)	Accessories			
				Remote Close Pneumatic	Remote Open/Close Pneumatic	Remote Open/Close Rotary	Electric Actuator
FVA6010	Viton	1¼" - 300# ANSI RF Flange	233 (NH ₃)	FA6016-60D	6016-60C	6016RA	6016EA
FA6010	Buna-N	1¼" - 300# ANSI RF Flange	259 (LP-Gas)				
FVA6016	Viton	2" - 300# ANSI RF Flange	640 (NH ₃)	FA6016-60D	6016-60C	6016RA	6016EA
FA6016	Buna-N	2" - 300# ANSI RF Flange	711 (LP-Gas)				
FVA6024	Viton	3" - 300# ANSI RF Flange	1173 (NH ₃)	FA6016-60D	6016-60C	6016RA	6016EA
FA6024	Buna-N	3" - 300# ANSI RF Flange	1325 (LP-Gas)				

* Not Available