

Reducer Coupling A5777

Application

Reduce a 3/4" ACME connection to a 1/4" ACME connection. Specifically designed to allow for operation of interlock switches which control the safety systems of transport vehicles to allow for the pump to be used for unloading and evacuation purposes. The stainless steel flange is flush mounted to the Acme reducer.

Features



- Resilient nitrile gasket to firmly seal connection against leaks and pressure loss

Materials

Gasket Nitrile
Flange Plate 300 Series Stainless Steel
Body Cadmium-Plated Steel & Brass



**A5777
Reducer Coupling**

Ordering Information

Part Number	Material	F. ACME Connection	M. ACME Connection
A5777	Brass	3/4"	1/4"

Equipped with Stainless Steel Flange

ACME Hose Couplings for Liquid or Vapor Service with Integral Screen 3195S and A3195S

Application

The 3195S/A3195S Hose Couplings are designed to prevent debris from entering and impeding the action of valves and components in LPG piping systems at bulk and industrial plants.

Features

- Meets NFPA 58 requirements for liquid transfer.
- Stainless steel screen installed in the tail piece of the hose coupling.

Materials

A3195

Body Ductile iron Nut & Cadmium-Plated Nipple

A3195S

Body Ductile iron Nut & Cadmium-Plated Nipple
Strainer 300 Series Stainless Steel



3195S

**Style B
For Liquid Filling**

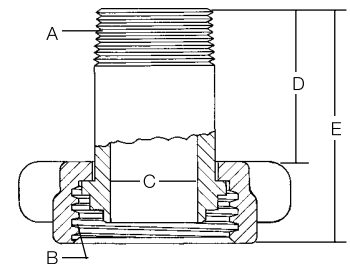

Ordering Information

Part Number	Material	Style	A. Hose Connection (M. NPT)	B. Coupling Connection (F. ACME)	C. Tailpiece Bore	D. Hose End To Nut	E. Overall Length
3195S	Brass Nut & Steel Nipple	B	2"	3/4"	1 1/8"	2 1/4"	3 3/8"
A3195S	Steel						