

External Hydrostatic Relief Valves

3125, 3127, 3129, SS8001, SS8002, SS8021 and SS8022 Series

Application

Designed especially for the protection of piping and shut-off valves where there is a possibility of trapping liquid LP-Gas or anhydrous ammonia. They may be installed in pipelines and hoses located between shut-off valves or in the side boss of RegO shut-off valves.



SS8022

Ordering Information

Part Number	Start To Discharge Setting PSIG	Valve Body Material	Container Connection M. NPT	Height (Approx.)	Wrench Hex Section	Accessories	
						Protective Cap	Pipeway Adapter or Threads
SS8001K**	375	Stainless Steel	1/4"	7/8"	11/16"	8001-55	-
SS8002K**			1/2"		7/8"	8022-54	-
SS8021K**			1/4"	1 1/8"	11/16"	8001-55	1/4" NPSM Thrds
SS8022K**			1/2"		7/8"	8022-54	3/8" NPT Thrds

Hose End Adapters for DOT Cylinder Filling 7193D-10 and 7193U-10

Application

Designed to provide quick and easy filling of DOT cylinders with POL or Type I connections. This adapter may be used with hydraulic and electric automatic systems or with manual systems in conjunction with a RegO 7901TB Quick Acting Shut-Off Valve.

These filling connectors have an extended connection on the handwheel, which makes it possible to connect the loading hose to valves on cylinders with fixed collars. The handwheel is well outside the collar for easy operation.

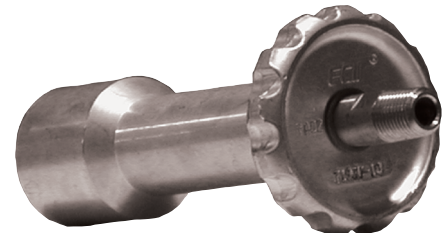

7193U-10S

Ordering Information

Part Number	Applications	Inlet Connection	Outlet Connection	Materials	
				"A" Nipple	"B" Handwheel Adapter
7193U-10S	Filling of DOT Cylinders with Type I Connections		Type 1 Connection (1 5/16" F. ACME)	Stainless Steel	Brass

High Pressure First Stage Regulators LV4403TR9V9 & LV4403TR96V9

Application

Provides accurate first stage regulation in two-stage bulk tank systems. Reduce tank pressure to an intermediate pressure of 5 to 10 PSIG (0.34 to 0.69 BARG). Also used to supply high pressure burners for applications like industrial furnaces or boilers. Also incorporated in multiple cylinder installations.



LV4403TR9V9

Ordering Information

Part Number	Inlet Connection	Outlet Connection	Orifice Size	Factory Delivery Pressure	Adjustment Range	Bonnet Vent Position	Vapor Capacity BTU/hr Propane*
LV4403TR9V9	F. POL	1/2" F. NPT	1/4" (6.25mm)	10 PSIG @ 50 PSIG Inlet (0.69 Bar @ 3.44 Bar inlet)	5-10 PSIG (0.34 - 0.69 Bar)	9 o'clock	2,500,000 BTU/hr (53 KG/hr)
LV4403TR96V9							

*Maximum flow based on inlet pressure 20 PSIG(1.4 bar) higher than the regulator setting and delivery pressure 20% lower than the regulator setting and delivery pressure 20% lower than the setting.