

Stainless Steel NPT Soft Seat Back Check SSA3186, SSA3196 and SSA3197

Application

Designed to provide protection of a container opening when desired flow is always into the vessel. May be used in line applications where flow must be limited to one direction.

When used with the appropriate single check filler valve, the combination forms a double check filler valve suitable for use in filling of bulk storage tanks.

Features

- Molded Seat & Retainer captures the seat disc in place to ensure positive placement
- Generous flow channels for low pressure drop.
- Heavy-duty Stainless Steel construction for long service life.
- Soft seat valves have synthetic rubber seat disc for positive seals.
- Temperature range of -40°F to +165°F (-40°C to +73°C)
- MAWP: 400 PSIG(27 Bar)

Materials

Body Stainless Steel
 Disc Stainless Steel
 Stem Stainless Steel
 Spring Stainless Steel
 Seat Disc Nitrile

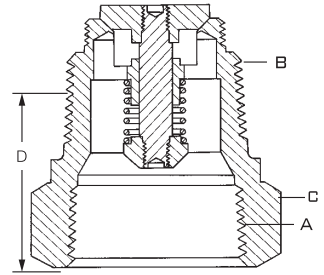

SSA3186

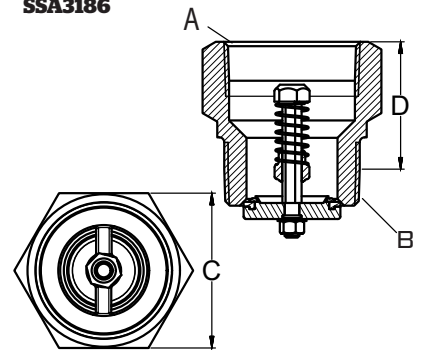

SSA3196

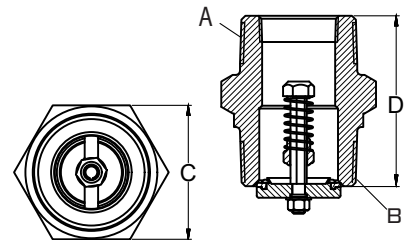

SSA3197

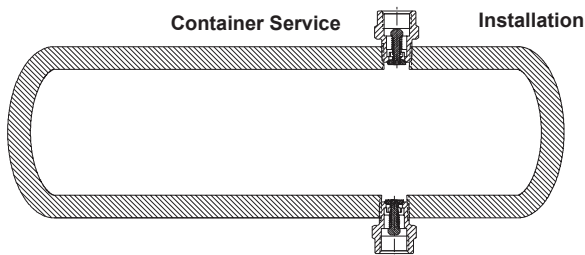

Ordering Information

Part Number	Inlet Connection	Outlet Connection	Wrench Hex Flats	Effective Length (approx.)	Propane Liquid Capacity at various differential pressures (GPM)			
					5 PSIG	10 PSIG	25 PSIG	50 PSIG
SSA3186	2" M. NPT	2" F. NPT	3"	2 ³ / ₈ "	124	175	276	391
SSA3196	3" M. NPT	3" F. NPT	4"	3 ⁷ / ₃₂ "	297	420	664	939
SSA3197		2" F. NPT/3" M. NPT		5 ⁹ / ₁₀ "				

NOTE: Multiply flow rate by .94 to determine liquid butane capacity and by .90 to determine liquid anhydrous ammonia capacity.

Stainless Steel Flanged Soft Seat Back Check SSA3186F and SSA3196F

Application

Designed to provide protection of a container opening when desired flow is always into the vessel. May be used in line applications where flow must be limited to one direction.

When used with the appropriate single check filler valve, the combination forms a double check filler valve suitable for use in filling of bulk storage tanks.

Features

- Molded Seat & Retainer captures the seat disc in place to ensure positive placement
- Generous flow channels for low pressure drop.
- Heavy-duty Stainless Steel construction for long service life.
- Soft seat valves have synthetic rubber seat disc for positive seals.
- Temperature range of -40°F to +165°F (-40°C to +73°C)
- MAWP: 400 PSIG(27 Bar)

Materials

Body	Stainless Steel
Disc	Stainless Steel
Stem	Stainless Steel
Spring	Stainless Steel
Seat Disc	Nitrile



COMING SOON



SSA3186F



SSA3196F

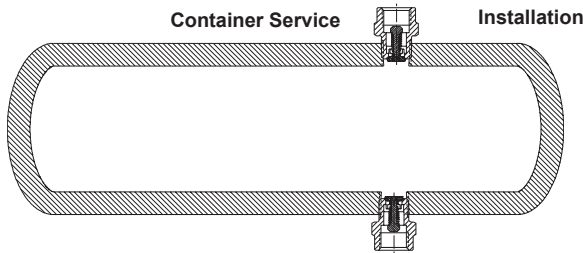

2" Flange Adapters (Packaged with O-ring & Bolts)

Part Number	Inlet Connection	Outlet Connection
SSA7513FAS	2" 4 Bolt Type B Flat Face w/ Bolts & O-Ring	2" Socket Weld
SSA7513FA		2" F. NPT

Ordering Information

Part Number	Inlet Connection	Outlet Connection	Wrench Hex Flats	Propane Liquid Capacity at various differential pressures (GPM)			
				5 PSIG	10 PSIG	25 PSIG	50 PSIG
SSA3186F	2" M. NPT	2" 4 Bolt Type A Groove	3"	124	175	276	391
SSA3196F	3" M. NPT		NA	297	420	664	939

NOTE: Multiply flow rate by .94 to determine liquid butane capacity and by .90 to determine liquid anhydrous ammonia capacity.

Stainless Steel Flanged Excess Flow Valve SSA3292 Series

Application

Designed to provide protection of a container opening when desired flow is always into the vessel. May be used in line applications where flow must be limited to one direction.

When used with the appropriate single check filler valve, the combination forms a double check filler valve suitable for use in filling of bulk storage tanks.

Features

- Generous flow channels for low pressure drop.
- Heavy-duty Stainless Steel construction for long service life.
- Soft seat valves have synthetic rubber seat disc for positive seals.
- Temperature range of -40°F to +165°F (-40°C to +73°C)
- MAWP: 400 PSIG(27 Bar)

Materials

Body	Stainless Steel
Disc	Stainless Steel
Stem	Stainless Steel
Spring	Stainless Steel
Seat Disc	Nitrile



COMING SOON

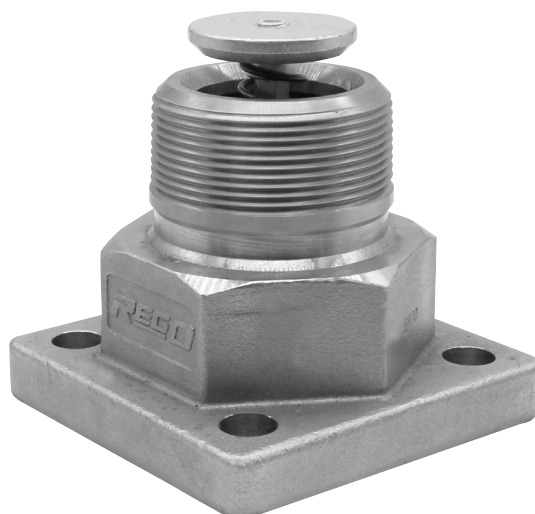

SSA3292F

Typical Installation

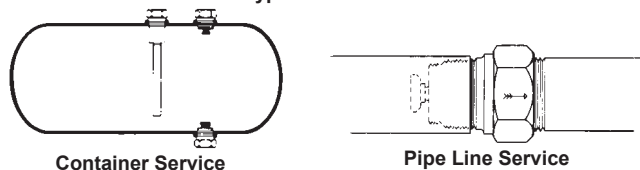

2" Flange Adapters (Packaged with O-ring & Bolts)

Part Number	Inlet Connection	Outlet Connection
SSA7513FAS	2" 4 Bolt Type B Flat Face with Bolts & O-Ring	2" Socket Weld
SSA7513FA		2" F. NPT

Ordering Information

Part Number	Inlet Connection	Outlet Connection	Wrench Hex Flats	Effective Length (Approx.)	Approximate Closing Flow*		
					Liquid (GPM Propane)	Vapor SCFH (Propane)	
						25 PSIG Inlet	100 PSIG Inlet
SSA3292AF	2" M. NPT	2" 4 Bolt Type A Groove	3"	3 ^{13/16"}	75	14,200	24,800
SSA3292BF					100	18,100	32,700
SSA3292CF					122	22,100	37,600
SSA3292DF					160	NA	NA

NOTE: Multiply flow rate by .94 to determine liquid butane capacity and by .90 to determine liquid anhydrous ammonia capacity.

* Based on horizontal installation of excess flow valve. Flows are slightly more when valves are installed with outlet up; slightly less when installed with outlet down.